



FOR SALE



# ASTRIMARE II

SANLORENZO SL86

BOATSTERS BLACK

**SANLORENZO**

**M/Y ASTRIMARE II**  
**Where Modern Italian Style Meets**  
**the Sea**

---

M/Y ASTRIMARE II, the 26.76-metre SL86 by Sanlorenzo, brings together style, speed, and the pure essence of life at sea. With a generous 6.35-metre beam and sleek planing profile, she delivers both performance and comfort, cruising smoothly at around 27 knots with a top speed of 32 knots.

Her flowing spaces and wide windows immerse guests in light and horizon, creating a calm and contemporary atmosphere for up to 8 guests across 4 cabins. More than a yacht, she is a refined escape where every moment feels effortless and every destination feels closer.

# A VISION REDEFINED

---

When Sanlorenzo created the SL line, it elevated the idea of a performance yacht into something far more architectural. The SL86 is the pure expression of this vision, where design becomes emotion and the sea becomes part of every space. M/Y ASTRIMARE II embodies this philosophy with confidence and beauty.

Her sleek profile and generous windows form a continuous dialogue with the surroundings, giving the yacht a presence that is both assertive and serene. The balance of sharp geometry and soft curves highlights the craftsmanship behind every surface. Nothing feels accidental every proportion reflects intention and lifestyle.





## A SPACE WITHOUT LIMITS

---

Inside, the SL86 invites a new way of living at sea. M/Y ASTRIMARE II offers a fluid main deck where salon, dining area, and navigation space connect naturally, creating one expansive environment shaped by light and openness. Wide windows embrace the horizon, turning every angle into a moving portrait of the ocean.



The design follows a simple idea comfort should feel effortless and modern. Refined materials, soft tones, and uncluttered furnishings come together to create a warm contemporary atmosphere. Aboard M/Y ASTRIMARE II, life flows with ease and every moment feels connected to the sea that surrounds you.

# A BOLD EXPRESSION OF POWERFUL PERFORMANCE AND REFINED COMFORT

---

M/Y ASTRIMARE II channels performance through thoughtful innovation. With twin MAN engines delivering strong acceleration and smooth cruising, she moves with confidence and ease across every coastline. Control and comfort work together to create a fast yet refined experience on the water.

Below deck, four elegant staterooms welcome up to eight guests in peaceful privacy. The full beam master suite mirrors the yacht's contemporary character, offering generous space and a serene atmosphere. Every detail reflects a commitment to comfort, style, and effortless living at sea.



# GENERAL

---

## MAIN

Brand	<b>Sanlorenzo</b>
Type	<b>SL86</b>
Year built	<b>2024</b>
Yacht name	<b>Astrimare II</b>
Build number	<b>#799</b>
Mooring	<b>Palma de Mallorca, Spain</b>
Status	<b>VAT Not Paid</b>
Registration	<b>Malta commercial</b>

## ACCOMMODATION

Cabins	<b>4+2</b>
Beds	<b>8+4</b>

## DIMENSIONS

Length	<b>26.76m</b>
Beam	<b>6.35m</b>
Draught	<b>1.8m</b>
Gross Tonnage	<b>90GT</b>

## SPEED & RANGE

Cruising speed	<b>27Kn</b>
Maximum speed	<b>32Kn</b>

# GENERAL

---

## CONSTRUCTION

Builder	<b>Sanlorenzo S.P.A.</b>
Hull material	<b>GRP</b>
Hull type	<b>Deep V</b>
Superstructure material	<b>GRP</b>
Deck material	<b>Teak</b>

## TANK CAPACITIES

Fuel	<b>8000l</b>
Water	<b>1700l</b>
Black water	<b>400l</b>

# ENGINES & TECHNICAL

---

## ENGINES & PROPULSION

Main Engines	<b>2x MAN D2868 LE 496</b>
Engine power	<b>2x 1000hp</b>
Type of Propulsion	<b>V - Drive</b>

## ENGINES & GENERATORS HOURS (19/12/2025)

Main Engines	<b>2x 348 hours</b>
Generator 1	<b>821 hours</b>
Generator 2	<b>808.8 hours</b>

## ELECTRICAL SYSTEM

Main Generators	<b>2x MASE IS27 (27kW)</b>
Battery charge(s)	<b>1x 100A service, 1x combi 100A service + 3kw inverter for electric, steering, 1 50A main engine batteries, 1x 10A recharge VHF battery, 1x 25A for generator batteries (OPT)</b>
Inverter	<b>1x 1500W for galley refrigerator/freezer</b>

# EQUIPMENT

---

## AUDIO / VIDEO

Televisions **1x in Master, 1x in Vip, 1x in Saloon, 2x in Guest (Samsung)**

---

Receiver **KVH TV6**

---

## NAVIGATION & COMMUNICATION

Radar **Yes**

---

Auto pilot **Yes**

---

VHF **Yes**

---

Compass **Yes**

---

Rudder angle indicator **Yes**

---

Internet **5G wifi system with harbor spot antenna & Predisposition for Starlink antenna on hardtop**

---

## EQUIPMENT

Bow thruster **Hydraulic 350KG**

---

Stabilizer **Zero speed fins (anchor and navigation)**

---

Air conditioning **105000 btu/h**

---

Watermaker **180lt/H (OPT)**

---

# EQUIPMENT

---

## DECK EQUIPMENT

Passarelle/Gangway	<b>Yes</b>
Crane	<b>Hydraulic Platform Max 550Kg</b>

## GALLEY & LAUNDRY

Diswasher	<b>Yes</b>
Microwave	<b>Yes</b>
Oven	<b>Yes</b>
Fridges	<b>Commercial type fridge/freezer "side-by-side"</b>
Wine cooler or fridge	<b>In Salon</b>
Ice maker	<b>In Salon</b>
Washing machine & Dryer	<b>Washer and dryer seperate in crew area</b>

# GENERAL ARRANGEMENT

---



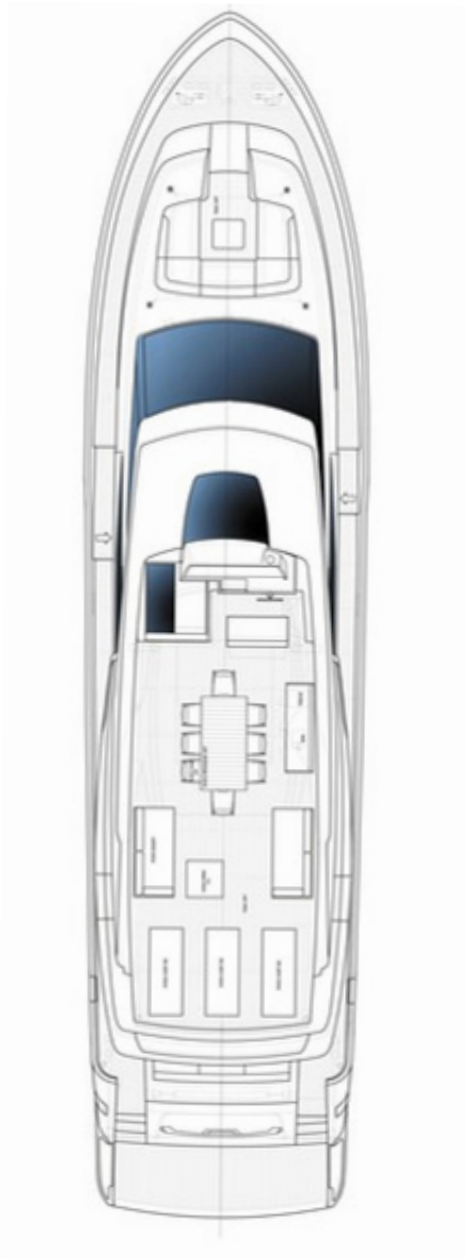

Flybridge

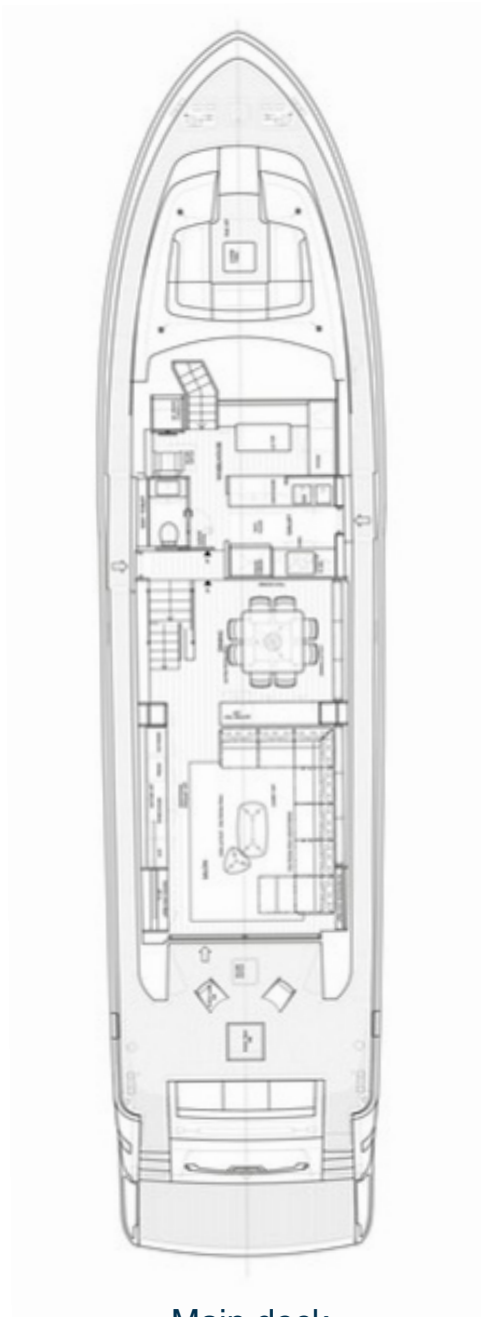

Main deck



Lower deck



















ASTRIMARE II

VALLETTA



*ASTRIMARE II*

VALLETTA















































BOATSTERS BLACK



 @boatstersblack

 /boatstersblack

 @boatstersblack

 /BoatstersOfficial

[boatstersblack.com](http://boatstersblack.com)

 **Spain (HQ)**  
Club de Mar-Mallorca, s/n, Muelle  
Pelaires, 07015 Palma,  
Balearic Islands  
+34 871 180 020

 **The Netherlands**  
Herengracht 420, 1017 BZ,  
Amsterdam  
+31 (20) 261 57 95

 **France**  
Antibes  
+33 627 278 622

 **Belgium**  
Zeedijk-Het Zoute 780, 8300,  
Knokke-Heist  
+32 475 259 231

 **Dubai**  
Tanzanite 1004, Tiara Residence,  
Palm Jumeirah, Dubai, UAE  
+971 55 286 0031

 **Portugal**  
Praça Duque de Saldanha 1  
2ºandar, 1050-094 Lisboa  
+351 910 418 447